



110 Courthouse Plaza  
Manhattan, Kansas 66502-0111  
Phone: 785-537-6350  
Fax: 785-537-6353  
E-mail: rl@listserv.ksu.edu  
www.rileycountyfair.com

July 9, 2018

Dear Friends,

The Riley County Fair Board is extending an invitation for your group to participate in the 2018 Fair Parade, Thursday, July 26 at 6:00 p.m. The parade will proceed out of the Manhattan Town Center going west on Poyntz Ave and ending at the city park. On the back of this letter is a map showing where to check in and the parade route.

Parade participants should arrive in the staging area at the NE corner of Dillard's parking lot at the Manhattan Town Center Mall. Please arrive Thursday, July 26 between 5:30 and 5:45 pm. This year's Riley County Fair theme is *Blue Jeans & Country Dreams*. This may be helpful as you design your parade entry.

Parade marshals (in an orange vest) will be on hand to assist in lining up parade entries. The marshals will be located in the NE corner of Dillard's parking lot of the Manhattan Town Center to direct the parade line up. **No pre-entry** is required for your organization to participate, just show up before parade time. There will be no set order for parade entries. Once you have checked in you will be directed to park entries in staging area. Parade marshals will direct you to pull into the line to begin the parade. Parking of extra vehicles will not be allowed in the staging area, however, the north lot of Dillard's can be used. We look forward to your participation in the 2018 Riley County Fair Parade.

***Notice: Due to a city ordinance, candy or other objects cannot be thrown from moving vehicles or parade floats. Objects can be handed out if desired.***

Sincerely,

A handwritten signature in black ink that reads "Gregg".

Gregg Eyestone  
County Extension Agent  
Horticulture

2018 Riley County Fair July 26-30

District I  
Mark Fritzon  
David Shipman  
Gavin Hargrave  
Marvin Haller

District II  
Danielle Anderson, President  
Josh Wendland, Vice President  
Lance Sharp  
Chris Anderson

District III  
Joyce Graham, Secretary  
Pam Nelssen  
Eva Peterson  
Sharon Dobesh-Beckman





Staging Area  
↓

Check In

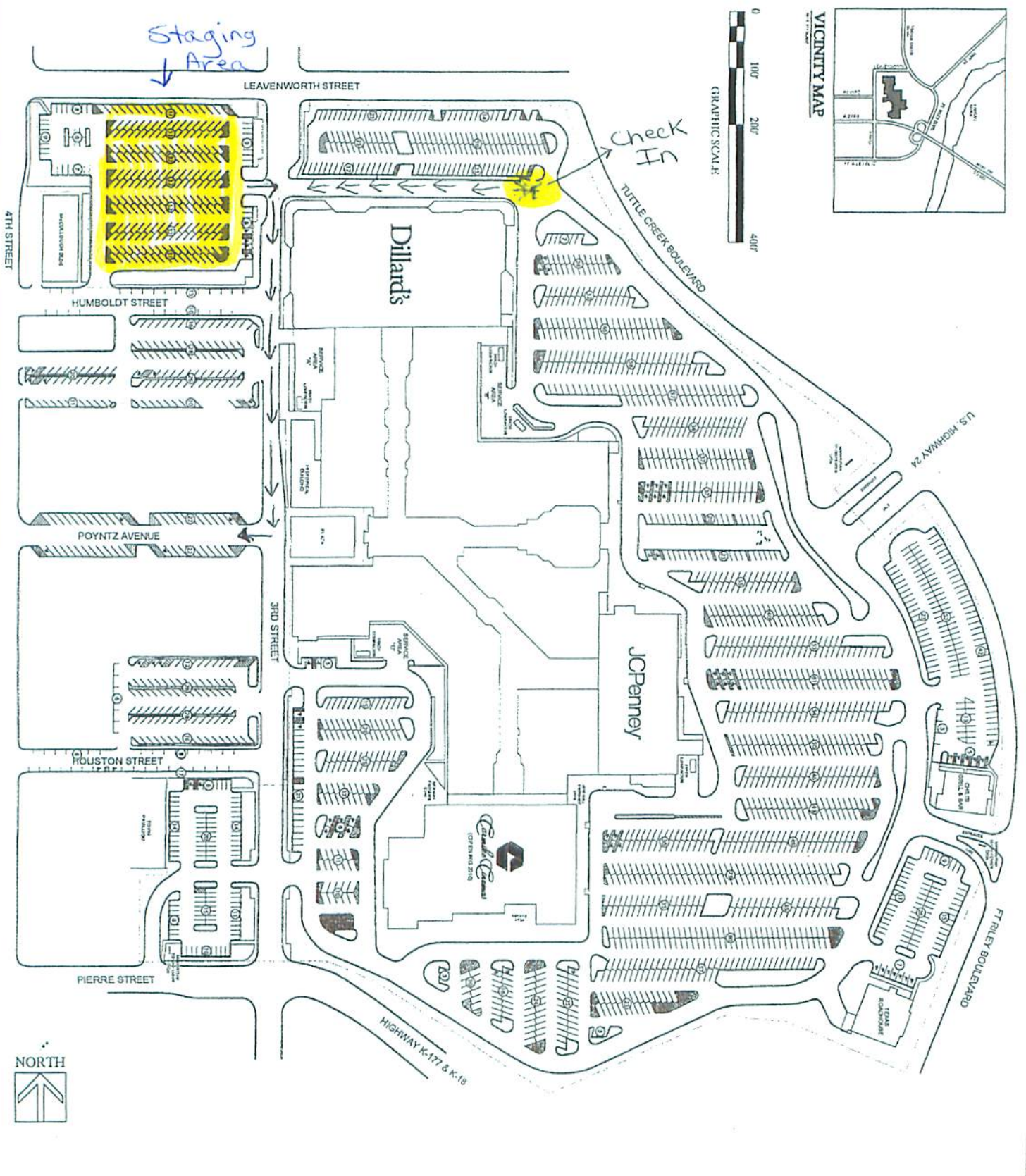

© 2016 CBRE, Inc. This information has been obtained from sources believed reliable. We have not verified it and make no guarantee, warranty or representation about it. Any projections, opinions, assumptions or estimates used are for example only and do not represent the current or future performance of the property. You and your advisors should conduct a careful, independent investigation of the property to determine to your satisfaction the suitability of the property for your needs.

**CBRE**  
 4520 Main Street  
 Suite 600  
 Kansas City, MO 64111  
 (816) 756-3535  
 www.cbre.com/ucr

**SITE PLAN**  
 LEASING & MANAGEMENT AGENTS

SEPTEMBER 2016

Approx. 8.7 Acres

PARKING & DRIVEWAYS	21.17 ACRES
BEERWALK	1.26 ACRES
BUILDING	19.84 ACRES
GREEN SPACE	4.27 ACRES
TOTAL ACROAGE	56.54 ACRES
TOTAL PARKING INCLUDED	2,270
HANDICAP SPACES	63

# MANHATTAN TOWN CENTER

## MANHATTAN, KS 66502